



Instruction Manual

DSP-1200



Thank you for purchasing the **DSP-1200**. Please read this manual before using the **DSP-1200**. When using the **DSP-1200**, always follow the instructions contained in this manual, and pay attention to the safety information.

WARNING!

Do not expose this product to water, rain or moisture.

Doing this can result in electric shock or fire.

Never take this product apart or try to modify it.

Doing so is very dangerous and could result in electric shock.

Do not store this product near open flame.

Do not use this product near open flame or place lit or flammable items, such as candles, incense, ect., on it.

Do not place any containers filled with water or other liquids near this product.

Doing so could result in fire or electric shock if the liquid spills and enters the product or gets it wet. If a liquid spills near this product, unplug the product immediately.

Do not remove or insert the power supply with wet hands.

Doing so could result in electric shock.

Do not use the power supply in any of the following ways.

Doing so could result in fire or electric shock.

Modifying or heating the power cable

Damaging the power cable

Bending or tugging on the power cable unnecessarily

Knotting or kinking the power cable

Setting heavy objects on the power cable

When moving this product , first unplug the power supply from the outlet. Do not tug the cable or move this product with the power supply plugged into the outlet.

Doing so could damage the cable, possibly resulting in fire or electric shock.

To reduce the risk of electric shock, do not remove the cover.

No parts inside the product can be serviced by the user. If your product needs service contact

Compu-Video Systems Inc. at (845) 737-7009.

Usage Environment

Avoid using or storing this product in areas such as those listed below. Doing so could damage the product or cause it to malfunction.

Areas exposed to heat or flames

Humid areas and areas where water is used

Handling this product

Do not drop or apply a strong force to this product or any included or connected parts.

Do not spill liquids around or inside this product or drop flammable objects around or inside it.

Power Supply

Only use the supplied power supply which is designed specifically for this product.

Do not allow the plug to come into contact with metal or water.

This Product is not designed for contact medical use

Do not use this product for medical applications that could result in patient contact.

The DSP-1200 is a 2 camera video screen splitter that does not require any genlock feeds for the cameras. By using digital technology CVS is able to capture and synchronize one camera to another so that the pictures can be split. The size, type and position of the split (Fig. 1) are variable as is the position of the second camera in relation to the first (Fig. 2).

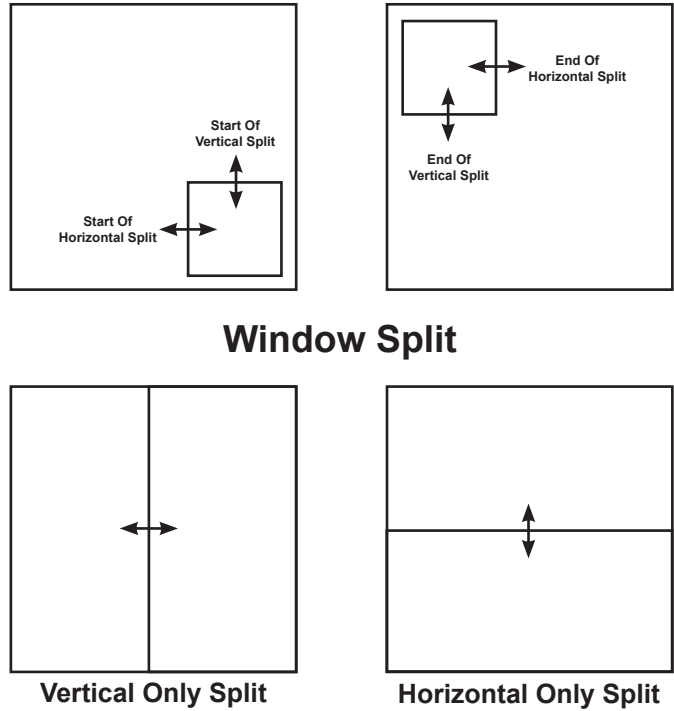

The position or what part of camera 2 shows in the window is adjustable both horizontally and vertically.

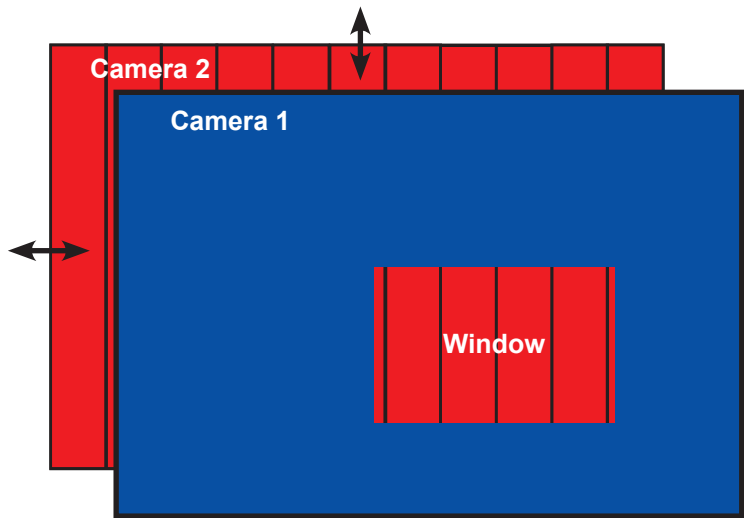

Camera Requirements: The DSP-1200 will work with any line locked or internally locked color or B&W cameras for input 1 and 2. Either camera can be line locked or internally locked, however the internally locked camera will give you a better picture. Both cameras must conform with RS-170A sync timing standards. This means they must also be interlaced with the proper pulse widths and sync frequencies. It has been found that some of the less expensive cameras while claiming to conform with RS-170A, actually do not. This can cause instability in either picture. If you are unsure of the RS-170A sync standard, please contact **Compu-Video Systems at 845-737-7009**.

Installation:

To set up the screen splitter we recommend you use the following check list to make the process simple.

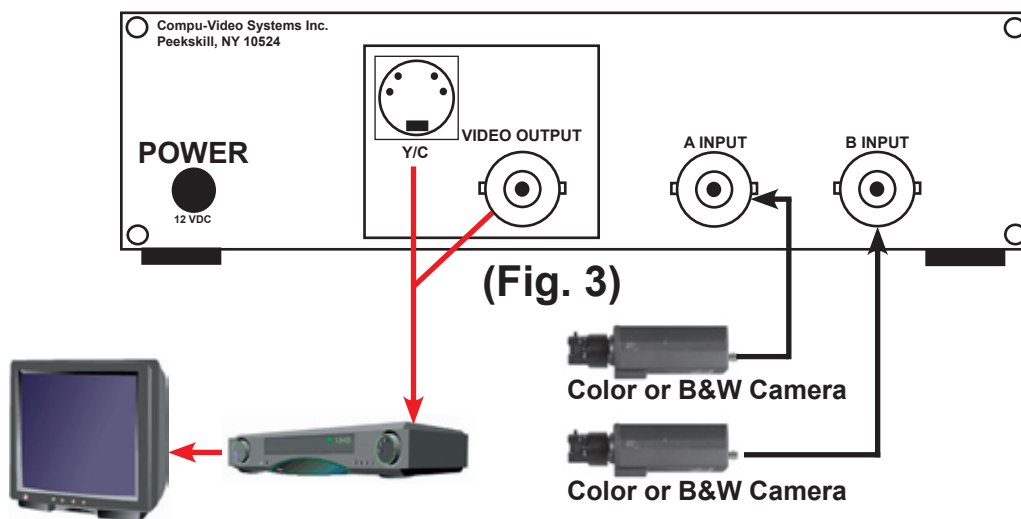

1. Connect video cables as per figure 3.
2. Connect power adaptor to unit
3. Plug in power adaptor to AC

SETUP/ALIGNMENT

- Install the cameras to cover the areas to be viewed. Take care that the area of camera 2 that you want to see in the split is in the center of the picture.
- Locate yourself at the screen splitter. With the front panel switch, verify that each camera shows individually on the screen.
- Decide on the type of split that you will use. Example: Vertical split, Horizontal split, Window.
- Decide where the split will be, and in the case of the window, what size it will be.

Channel B Mirror Mode: The units are shipped in Normal Mode. If you want to activate Channel B Mirror Mode see figure 4 and follow the steps listed below.

- 1) Disconnect the power
- 2) Remove the cover
- 3) Set jumper #1 to the rear as shown in the following diagram.
- 4) Re-install the cover
- 5) Connect the power

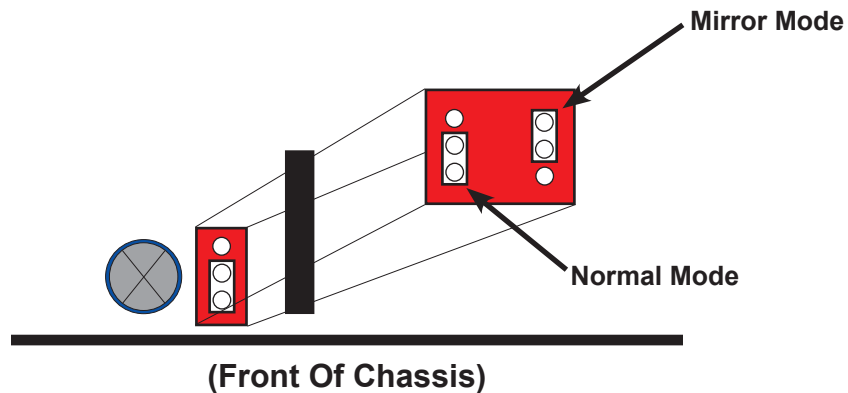

(Front Of Chassis)

(Fig. 4)

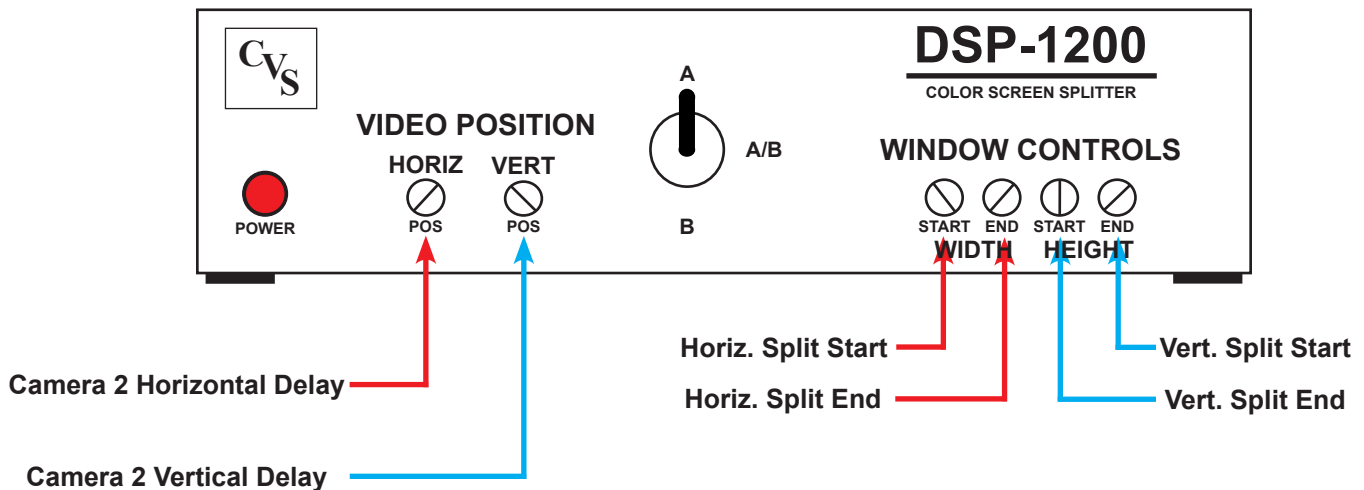

- 
- Set the front panel switch to the center split position.
 - It is recommended that you center the controls and vary each one while observing the picture. This will give you a feel for the way each control effects the picture.
 - Begin by adjusting the start of the split with the Height Start Control. Position the start of the split as desired.
 - Next set the end of the vertical split to its desired location using the Height End Control.
 - If you are setting the window/split so it goes to the far right side of the screen, perform the following steps:** On the Width end control, vary this control to the minimum split and slowly increase it so that the split goes to the right. Once you go past the end of the screen you can continue. You will see no increase in split size but you will see the picture jump to the side at a point. This indicates that you have gone too far and need to adjust the control back to just before the picture jumps.
 - Adjust the Width Start to position the left side of the split
 - Adjust the Width end control to end the Horiz split. You now have a window that should be positioned in camera 1.
 - If selected, Adjust the Vertical position to center camera 2 in the window. You can open the window with the Width and Vertical End controls to make this step easier. Once camera 2 is properly set, close the window down to the desired size.
 - After the split has been set, touch up the Horizontal and Vertical position controls to get the slave camera's optimum picture angle. If the vertical delay is disabled, only the horizontal position will work.

NOTE:

Once you have set up the unit and there is a slight side to side jumping on camera 2, slightly adjust the Camera 2 Horiz delay to stabilize it.

Limited Warranty:

Compu-Video Systems warrants this product and all accessories provided with it to be free of defects in material and workmanship for a period of 5 years after the original date of purchase. This warranty does not cover damage to the product resulting from accident, misuse or modification.

How The Warranty Works

If this product, or any of the accessories supplied with it, become defective within the warranty period, Compu-Video Systems Inc. will at its discretion repair, or replace the product with an equivalent unit of equal or higher value without charge. Overland return transportation from Compu-Video Systems Inc. to the user is free of charge.

How To Get Service

Please contact CVS by phone for return authorization number and then return the defective unit, transportation prepaid and a dated proof of purchase to:

**Compu-Video Systems Inc.
37 Arden Drive
Garrison, NY 10524**

The customer is responsible for all costs incurred from shipping the product back to Compu-Video Systems.

Obtaining Technical Help/Service

Web Site: www.compuvideosystems.com
Phone: (845) 737-7009
Fax: (845) 737-0426

In no event shall Compu-Video Systems Inc. be liable for Consequential Damages.

Some states do not allow exclusion or limitation of incidental or consequential damages, so the above limitation may not apply to you. This warranty gives you specific legal rights, and you may also have other rights which vary from state to state.

**Have A Video Picture Problem?
Give Us A Call At (845) 737-7009 For Free Tech Support.
We May Have The Answer You Are Looking For.**

